

## Unicase

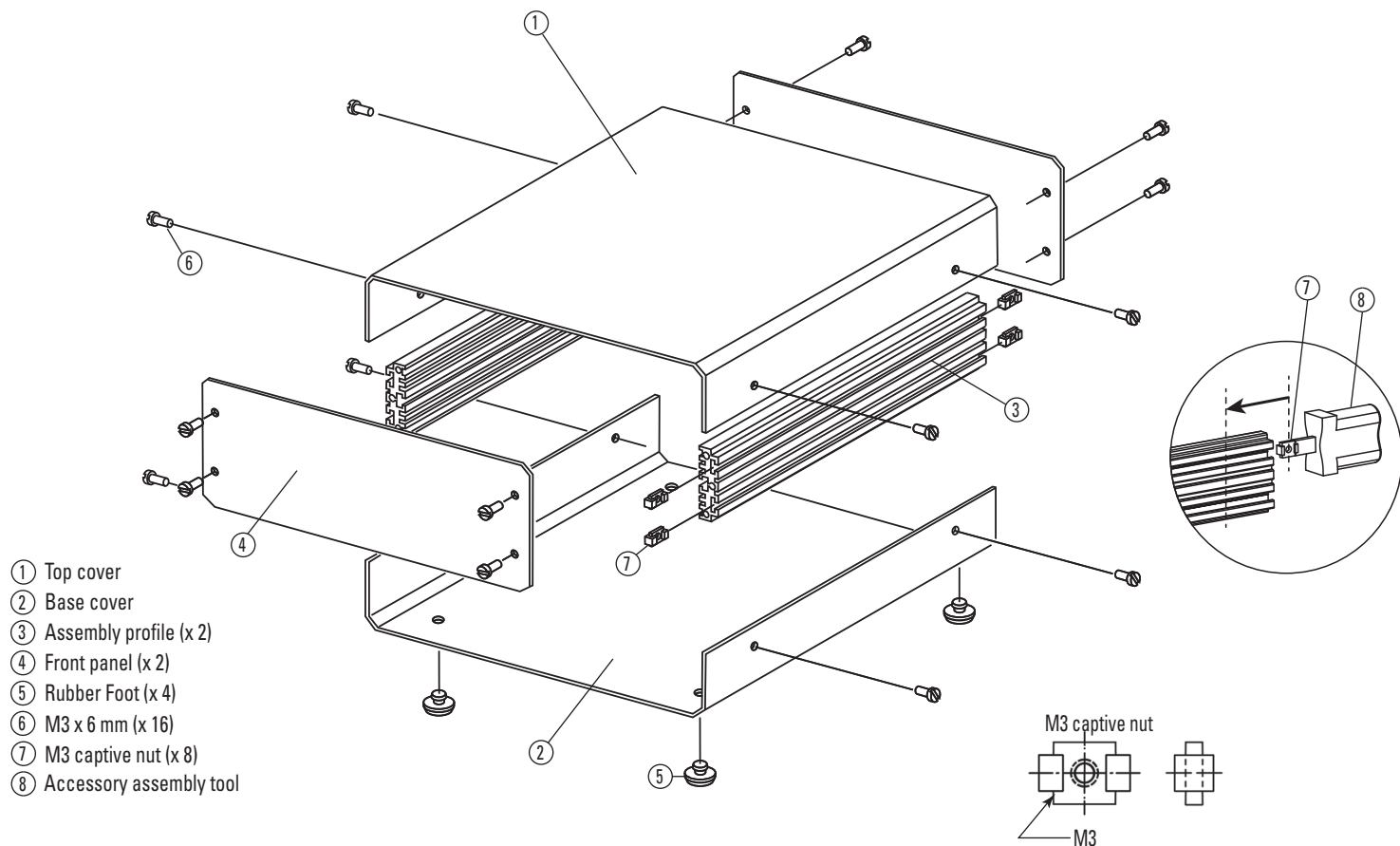

- ① Top cover
- ② Base cover
- ③ Assembly profile (x 2)
- ④ Front panel (x 2)
- ⑤ Rubber Foot (x 4)
- ⑥ M3 x 6 mm (x 16)
- ⑦ M3 captive nut (x 8)
- ⑧ Accessory assembly tool

### Grey RAL 7035 Lichtgrau/Gris clair

Part No. Bestell-Nr./Réf.	Version
M 55 01 110	Unicase 1
M 55 02 110	Unicase 2
M 55 03 110	Unicase 3
M 55 04 110	Unicase 4
M 55 05 110	Unicase 5
M 55 06 110	Unicase 6

Part No. Bestell-Nr./Réf.	Version
M 55 11 110	Unicase SL1
M 55 12 110	Unicase SL2
M 55 13 110	Unicase SL3
M 55 14 110	Unicase SL4

### Black RAL 9005 Schwarz/Noir

Part No. Bestell-Nr./Réf.	Version
M 55 01 119	Unicase 1
M 55 02 119	Unicase 2
M 55 03 119	Unicase 3
M 55 04 119	Unicase 4
M 55 05 119	Unicase 5
M 55 06 119	Unicase 6

Part No. Bestell-Nr./Réf.	Version
M 55 11 119	Unicase SL1
M 55 12 119	Unicase SL2
M 55 13 119	Unicase SL3
M 55 14 119	Unicase SL4

### Assembly Tool Accessory

Montagewerkzeug Zubehör/Accessoire d'outil d'assemblage

Part No. Bestell-Nr./Réf.	Version
M 55 00 001	Universal

## Assembly Procedure

1. Insert four rubber feet into case bottom.
2. Insert eight M3 captive nuts into the two assembly profiles. **(Option:** for fast and easy assembly, insert captive nuts using assembly tool accessory 'M5500001')
3. Secure the two assembly profiles to the case bottom using four of the M3 x 6 screws (fastening to the captive nuts).
4. Secure the case top to the assembly profile as per step 3.
5. Secure the front panels using the remaining M3 x 6 screws (fastening to the front and rear of the assembly profiles). The case is now ready for use.